

**BC BUILDING CODE INTERPRETATION COMMITTEE
AIBC, APEGBC, BOABC, POABC**

File No: 98-0140

INTERPRETATION

Page 1 of 1

Interpretation Date:

September 20, 2005

Building Code Edition:

BC Building Code 1998

Subject:

Integrity of Exits

Keywords:

exits

Building Code Reference(s):

3.4.4.4.(1)(d), 3.4.4.4.(6), 3.4.6.11.

Question:

Can a door from a floor area, other than the required exit door, open directly into an exit?

Interpretation:

No.

Clause 3.4.4.4.(1)(d) states that a fire separation that separates an exit from the remainder of the building shall have no openings except for exit doorways.

Sentence 3.4.4.4.(6) allows an exit to be designed to serve as an access to a floor area. This means one can use the exit doorways to access the floor area.

Any door opening into an exit enclosure from a floor area must be designed as an exit door which has a fire-protection rating and swings in the direction of exit travel in conformance with Sentence 3.4.6.11.

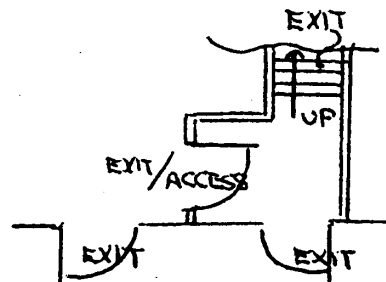



R. J. Light, Committee Chair

The views expressed are the consensus of the joint committee of AIBC, APEGBC, BOABC, and POABC, which form the BC Building Code Interpretation Committee. The purpose of the committee is to encourage uniform province wide interpretation of the BC Building Code. These views should not be considered as the official interpretation of legislated requirements based on the BC Building Code, as final responsibility for an interpretation rests with the local *Authority Having Jurisdiction*. The views of the joint committee should not be construed as legal advice.